

Tech Specs

[UniFi](#) [UISP](#) [Branding](#)

[WiFi](#) [Switching](#) [Cloud Keys & Gateways](#) [Camera Security](#) [Door Access](#) [Power Tech](#) [New Intro](#)

Door Access > [G2 Starter Kit](#)

[Datasheet](#)

[Marketing Images](#)

[Installation Guide](#)

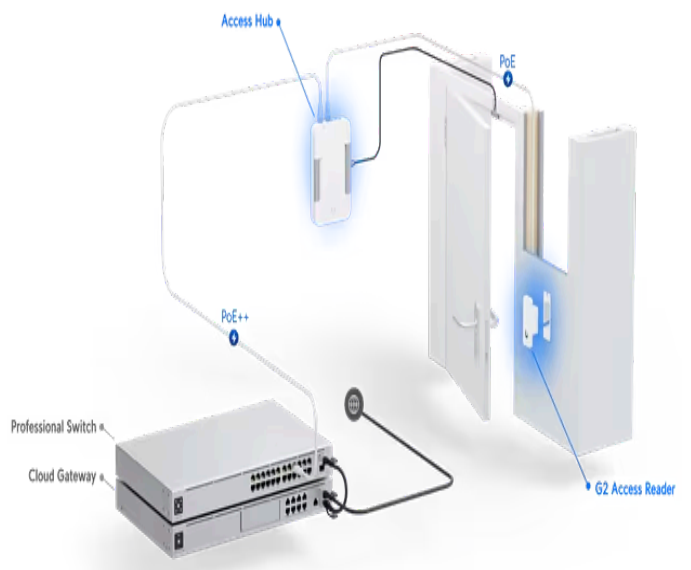
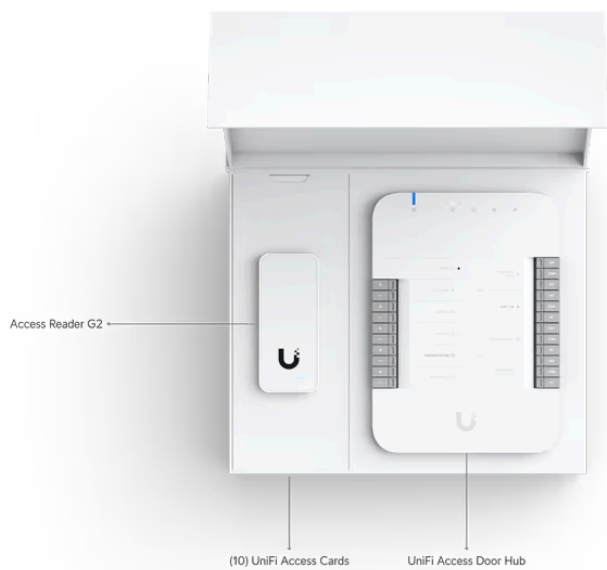

UA-Hub-Door Mechanical

Dimensions 174.9 x 126 x 32.9 mm (6.9 x 5 x 1.3")

Weight 363 g (12.8 oz)

Enclosure material Polycarbonate

Mounting material Polycarbonate

Hardware

Networking interface	(5) 10/100/1000 Base-T
Power method	PoE++ UL 294 Power-limited Class 2 PSU UL 60950/62368 LPS/PS2 PSU
Max. power consumption	Without PoE output: 30W With PoE output: 50W
PoE input	50V DC, 1A
PoE output	PoE passthrough, (4) PoE, 50V DC, total 20W
Button	(1) Factory-reset
LEDs	System: white/blue Output relays: white
Digital input	Request to exit/request to enter/remote release/door position sensor
Dry output relay	Lock: 30V DC, 1A Aux: 30V DC, 1A
Powered output relay	Lock: 12V DC, 1A Aux: 12V DC, 0.33A 12V DC, 0.33A
Operating environment	Indoor use only
Ambient operating temperature	0 to 40° C (32 to 104° F)
Ambient operating humidity	5 to 95% noncondensing
UL 294 level	Destructive attack: Level I Line security: Level I Endurance: Level I Standby power: Level I
UL 294 statement	Compliance with IEEE 802.3 (at or af) specifications was not verified as part of UL The equipment is intended to comply with the section of the National Electrical C Article 725.121, Power Sources for Class 2 and Class 3 Circuits.
CAN/ULC-60839-11-1 Grade	Grade assignment: 1
Certifications	CE, FCC, IC, UL 294, CAN/ULC-60839-11-1

Wiring Information

Wiring gauge requirements (AWG)	Total length to device	Output load current at 12V DC	
		100mA	250mA
	6.1 m (20 ft)	22	22
	15.2 m (50 ft)	22	22
	30.5 m (100 ft)	22	22

UACC-Cable-DoorLockRelay (18 AWG) is recommended.

PoE cabling requirements

The minimal conductor gauge permitted to connect between the PSE or power injector and the device is 24 AWG (0.21 mm²) for horizontal or riser cable.

LEDs

PoE in

Steady blue: Adopted/device is ready
Steady white: Pending adoption
Blinking white/blue: Upgrading firmware

PoE out

Off: Not connected or no data link
Steady blue: Connected and data link on

UA-G2

Mechanical

Dimensions

93 x 40 x 36.5 mm (3.7 x 1.6 x 1.4")

Weight

82 g (2.9 oz)

Enclosure material

Polycarbonate, glass

Mounting

In wall, gang box

Weatherproofing IP55

Hardware

Networking interface	(1) 10/100 MbE RJ45 port
Connectivity	BLE 4.1
Power method	PoE UL 294 Power-limited Class 2 PSU UL 60950-1/62368-1 LPS/PS2 PSU
Supported voltage range	48V DC
Max. power consumption	5W
ESD/EMP protection	Air: ±15kV, contact: ±8kV
Sensors	Proximity sensor
Speaker	(1) 8 ohm, 0.7W
LEDs	R/G/B/W
Button	(1) Factory-reset
NFC frequency	13.56 MHz
NFC read range	< 30 mm
NFC standards	ISO 14443A, 14443B, 15693
NFC technology	NFC Tag 1,2,3,4,5 MIFARE Classic MIFAREPlus MIFARE Ultralight MIFARE DESFire
Operating environment	Outdoor use
Ambient operating temperature	-30 to 45° C (-22 to 113° F)
Ambient operating humidity	5 to 90% noncondensing
Software information	The software version of a product can be checked at https://unifi.ui.com
UL 294 level	Destructive attack: Level I Line security: Level I

Endurance: Level I
Standby power: Level I

UL 294 statement

Compliance with IEEE 802.3 specifications was not verified as part of UL 294. The equipment is intended to comply with the section of the National Electrical Code Article 725.121, Power Sources for Class 2 and Class 3 Circuits.

PoE cabling requirements

Cable 5e cabling is the minimum performance category recommended. The performance should match the transmission speed required at the installation site. The minimal conductor gauge permitted to connect between the PSE or power injector is 26 AWG (0.13 mm²) for patch cords; 24 AWG (0.21 mm²) for horizontal or riser cabling.

CAN/ULC-60839-11-1 Grade

Grade assignment: I

Certifications

CE, FCC, IC, UL 294, CAN/ULC-60839-11-1

Document number, and issue date and/or revision level

UA-G2/UA-G2-Black, V02

LED

System

Steady blue: Adopted/device is ready
Steady white: Pending adoption
Blinking white/blue: Upgrading firmware
Strobing red: Emergency lockdown

UA-Card

Mechanical

Dimensions

85.6 x 53.98 x 0.84 mm (3.37 x 2.13 x 0.03")

Weight

5 g (0.18 oz)

Format

ISO 7810 ID-1

NFC frequency

13.56 MHz

NFC technology

ISO/IEC 14443 Type A
MIFARE DESFire
UniFi Access Proprietary Security Protocol

Stay in Touch

[Terms and Conditions](#) | [Terms of Service](#) | [Privacy Policy](#) | [Return Policy](#) | [Cookies Settings](#)

© 2024 Ubiquiti, Inc. All rights reserved.